

Maintenance

In the event of heater failure please contact the distributor in the first instance. For spare parts or advice, please contact the manufacturer.

- Disconnect from the mains before commencing any maintenance procedure including cleaning.
- To ensure optimum heat effectiveness, it is recommended that after the heater has been used approximately 80-100 hours, the front glass is opened and both the front glass and the reflector are wiped with a lint-free cloth before resealing.
- If at any time, a white deposit is seen on the inside of the glass or on the reflector, either or both should be cleaned with a lint-free cloth.
- The heater is supplied with toughened safety glass. In the unlikely event that this should become cracked, please contact the manufacturer for an immediate replacement.

Replacing the emitter

1. Disconnect the power supply and ensure that the emitter is not illuminated and that the heater body and emitter are cool.
2. Unscrew the back 2 screws at the top of the casing. See Fig 1.
3. Open the hinged front cover. See Fig 2.
4. Remove the emitter from the spring loaded holders by pushing one end further into its holder and by pulling the end that is free towards you, as shown in Fig 3.
5. Refit in reverse order.
6. For replacement emitter (AL013), please contact the manufacturer.

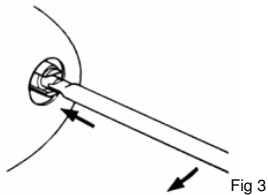
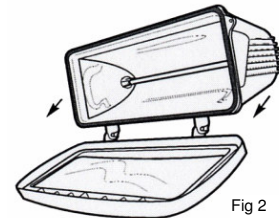
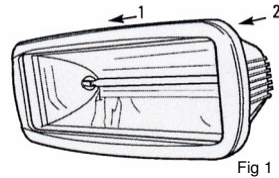

Caution: Do not handle the emitter with bare hands. Remove finger marks with a lint-free cloth and methylated spirits or alcohol. Finger marks will burn into the quartz emitter causing premature emitter failure.



Issue 1 2005 / Part No. 042038B

T A N S U N Q U A R T Z H E A T

Reference Manual

MODELS ALG 213 & ALG 212 USA/CANADA



T A N S U N L I M I T E D

Spectrum House, Unit 1, Ridgacre Road, West Bromwich, West Midlands, B71 1BW, England.

Tel: +44 (0)121 580 6200 · Fax: +44 (0)121 580 6222

Email: quartzinfo@tansun.co.uk · Website: www.quartzheat.com

Introduction

The Algarve patio heater produces radiant heat like the sun, warming people and objects and not the air in between, providing the only form of heat that will not blow out or away. The Algarve is primarily designed for outdoor use and is therefore weatherproof.

Please read the enclosed instructions carefully before use. The safety of this heater is guaranteed only by the correct usage in accordance with these instructions, therefore it is recommended that they are retained for future reference.

Caution

Before using this appliance:

- Check that the voltage indicated on the type plate corresponds to the mains supply voltage.
- Ensure that the heater has been securely fastened in its final mounting position.
- Disconnect from the mains during installation, cleaning and/or replacing the emitter and always ensure that the emitter is cool.
- Do not handle the halogen emitter with bare hands. If it is inadvertently touched, remove finger marks with a soft cloth and methylated spirit or alcohol. Otherwise, the marks will burn into the quartz emitter causing premature heater failure.
- Touch the front glass as little as possible in order to avoid unsightly grease residue.
- Do not use an extension cable with this product.
- Keep the mains cable away from the body of the heater which will get hot during use.
- Do not cover or obstruct the heater while it is in use.
- Ensure that children do not tamper with the heater.
- Do not insert any object through any slot or opening in the heater.
- Do not use if glass is broken.
- For the US/Canada — Use only on 15 ampere branch circuit
- Do not install less than 2.5m (8' 2") from the floor

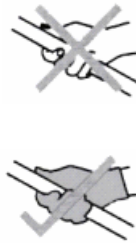

Risk of fire $\left(\left| \text{---} 0.9\text{m} \right| \right)$

Keep combustible materials such as furniture, papers, clothes and curtains at least 3 feet (0.9m) from the front of the heater and away from the sides and rear. If the lamp is to be used outside, we recommend that a waterproof or indoor socket is used.

Table 1: Specification*

Specification	ALG 213	ALG 212
Voltage (V)	230	120
Total power (kW)	1.3	1.2
Amps (A)	5.7	10
Minimum mounting height from floor	2.5m	8' 2"
Minimum distance from ceiling	0.5m	1' 7½"
Minimum distance from side wall	1.5m	4' 11"
Dimensions W x H x D	400mm x 180mm x 170mm	15¼" x 7" x 6¾"
Weight	2.85kg	6lb
Insulation class	1	1
Lampholder	R7S	R7S
Ingress protection	IP54	IP54

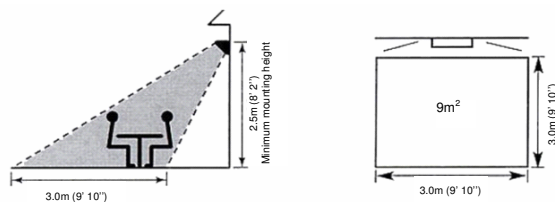

* All measurements are nominal and subject to change without prior notification

Installation

Wiring

- Warning - this appliance must be earthed.
- The wired versions (213/UK 213/EU & 212/US) are fitted with 5 metres of supply cable and a moulded plug, therefore it is unnecessary to remove the terminal box in order to carry out normal installation of these models.
- All unwired versions should be installed by a suitably qualified electrician, following the instruction below.
- All installations must be in accordance with the I.E.E safety regulations or equivalent.
- We recommend using a RCD where applicable.
- If the supply cord becomes damaged, it must be replaced by the manufacturer, its service agent or a similar qualified person in order to avoid a hazard.
- When the electrical connection is outside, it is recommended that a waterproof socket is used for the connection/terminal. Otherwise, the plug should be connected to a socket indoors.
- If in any doubt, please contact a suitably qualified electrician.

- Unscrew the terminal box cover at the back of the heater and feed the supply cable through the compression gland.
- Use a heat resistant supply cable with 2 poles and earth. The live and neutral wires must be connected to the terminal block. See Fig 1.
- The green/yellow wire should be connected to the clamp marked with the earth symbol. \oplus
- Tighten the barrel nut of the compression gland so that the rubber seal grips the cable. The seal can be adjusted to accommodate cables of diameter between 8mm and 11mm (approx 3/8"). See Fig 2.
- Ensure that the cover is secured well - prevent water ingress.

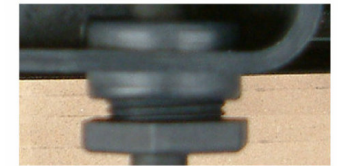
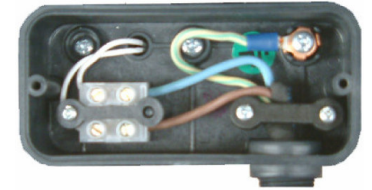

Fig 2

Mounting

- Securely fasten the bracket to the mounting surface using the fixing holes in the mounting bracket. Note: Fixings not included.
 - Securely fasten the heater on the bracket using the nut and bolt supplied. See Fig. A and Fig. B.
- The heater must be mounted in such a way that the halogen emitter does not slant more than 4° from the horizontal.
 - Allow the heater to cool before attempting to reposition/move. Never attempt to move the heater while it is switched on.
 - Observe the minimum safe distance between the heater body and inflammable surfaces when mounting.
 - Please refer to Table 1 for the recommended positioning of the heater.
 - Keep out of the reach of children.

